

EST. 2009

Sanderson

A R C A D E

MORPETH, NORTHUMBERLAND, NE61 1NS



RETAIL
& OFFICE
OPPORTUNITIES

M&S
EST. 1884

MINT VELVET

FATFACE

HOBBS
LONDON

Phase Eight

JoJo Maman Bébé
maternity | baby and child | nursery and toys

— COOK —

OLIVER BONAS

THE WHITE COMPANY
LONDON



SEASALT
CORNWALL

RETAIL UNITS AND SITE PLAN

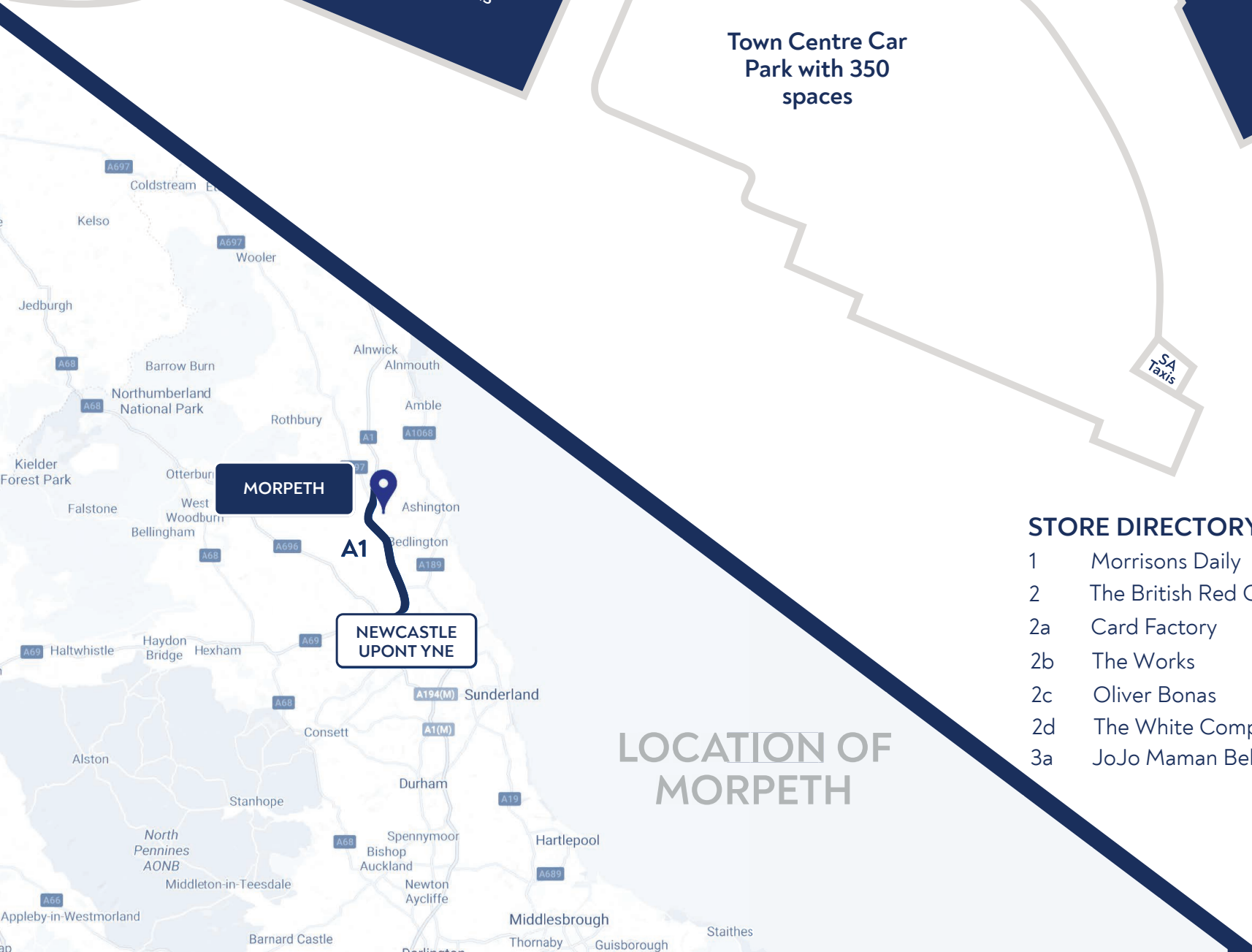

LOCATION OF MORPETH

STORE DIRECTORY

1	Morrisons Daily	3b	Phase Eight	9	Crew Clothing	19	Weird Fish
2	The British Red Cross	3c	Mountain Warehouse	10	Mr Simms Sweet Shop	20	Cook
2a	Card Factory	3d	Barluga Restaurant	11	Vision Express	21	Central Bean
2b	The Works	4	Signature North East	12	Vodafone	22/23	Martino Lounge
2c	Oliver Bonas	5	Waterstones	13	Hobbs	24	Marks & Spencer
2d	The White Company	5a	Mint Velvet	14	Rieker Shoes	26	Timpson
3a	JoJo Maman Bebe	5b	Deborah Green Jewellers	14a	EE	27/28	The Morpeth Larder
		6	Clarks	15	The Jewellers Guild	Kiosk 3	The Eyebrow Gallery
		7	Seasalt	16/17	Enjoy	Kiosk 4	Catling Bakery
		8	Fat Face	18	Market Cross Jewellers	Kiosk 5	Arriva

OFFICE SPACES

Located on the 1st floor of Austin, Davison, Lumley & Owen House

- From 170sqft to 3,500sqft
- Lift access
- High specification
- Suit a variety of uses

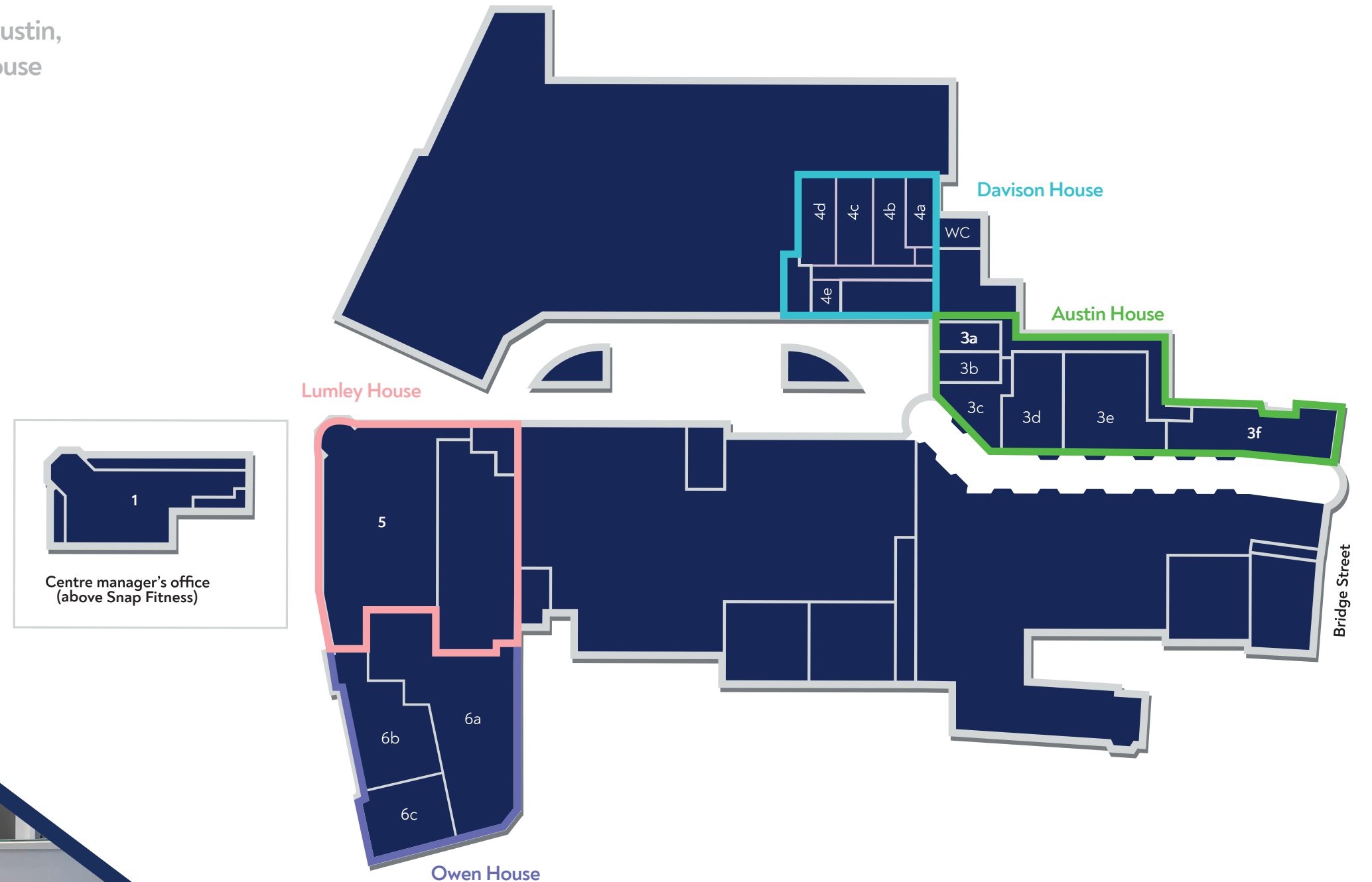

Lumley House

- 1 Centre Managers Office
- 5 Snap Fitness

Austin House

- 3a The Eaga Trust
- 3b Pinky's Nail Boutique
- 3c Handelsbanken
- 3d Talentheads
- 3e Northumbria Police
- 3f Handelsbanken

Davison House

- 4a Advice 4 Business
- 4b Bridal Reloved
- 4c SG Aesthetics
- 4d Roll Lift
- 4e Riverstone Wealth Management

Owen House

- 6a Karbon Homes
- 6b D&P Asset Management
- 6c Dacre St Developments





Sanderson Arcade in Numbers

15 miles north of Newcastle in the beautiful Market Town of Morpeth

60,000 people per week (average footfall)

350 space town centre car park and a bus interchange

230,788 people in a 20 minute drive and 808,174 in a 30 minute drive

Launched in 2009 by Joanna Lumley OBE – welcoming its 25 millionth customer in 2019

Northumberland in Bloom Gold Award Winner

Adjacent town centre development with Next, Pets at Home and Home Bargains

42% of the 10 minute drive catchment falls into the three most affluent Acorn groups.

next

pets
at home

home bargains
TOP BRANDS - BOTTOM PRICES





CONTACT US: Dransfield

EST. 1992
PROPERTIES LIMITED

For further information about Sanderson Arcade and to arrange a viewing contact:

James Shepherd

Managing Director at Dransfield Properties

01226 360644 or 07789 817880

james.shepherd@dransfield.co.uk

www.sandersonarcade.co.uk

 @sandersonarcade  @SandersonArcade  @sandersonarcade

