

EST. 2009

Sanderson

A R C A D E

MORPETH, NORTHUMBERLAND, NE61 1NS



RETAIL
& OFFICE
OPPORTUNITIES

M&S
EST. 1884



HOBBS
LONDON
Phase Eight

JoJo Maman Bébé
maternity | baby and child | nursery and toys

FATFACE
C C
CREW CLOTHING COMPANY

EST. 2016
Sandersons
BOUTIQUE STORE
MINT VELVET



SEASALT
CORNWALL

RETAIL UNITS AND SITE PLAN

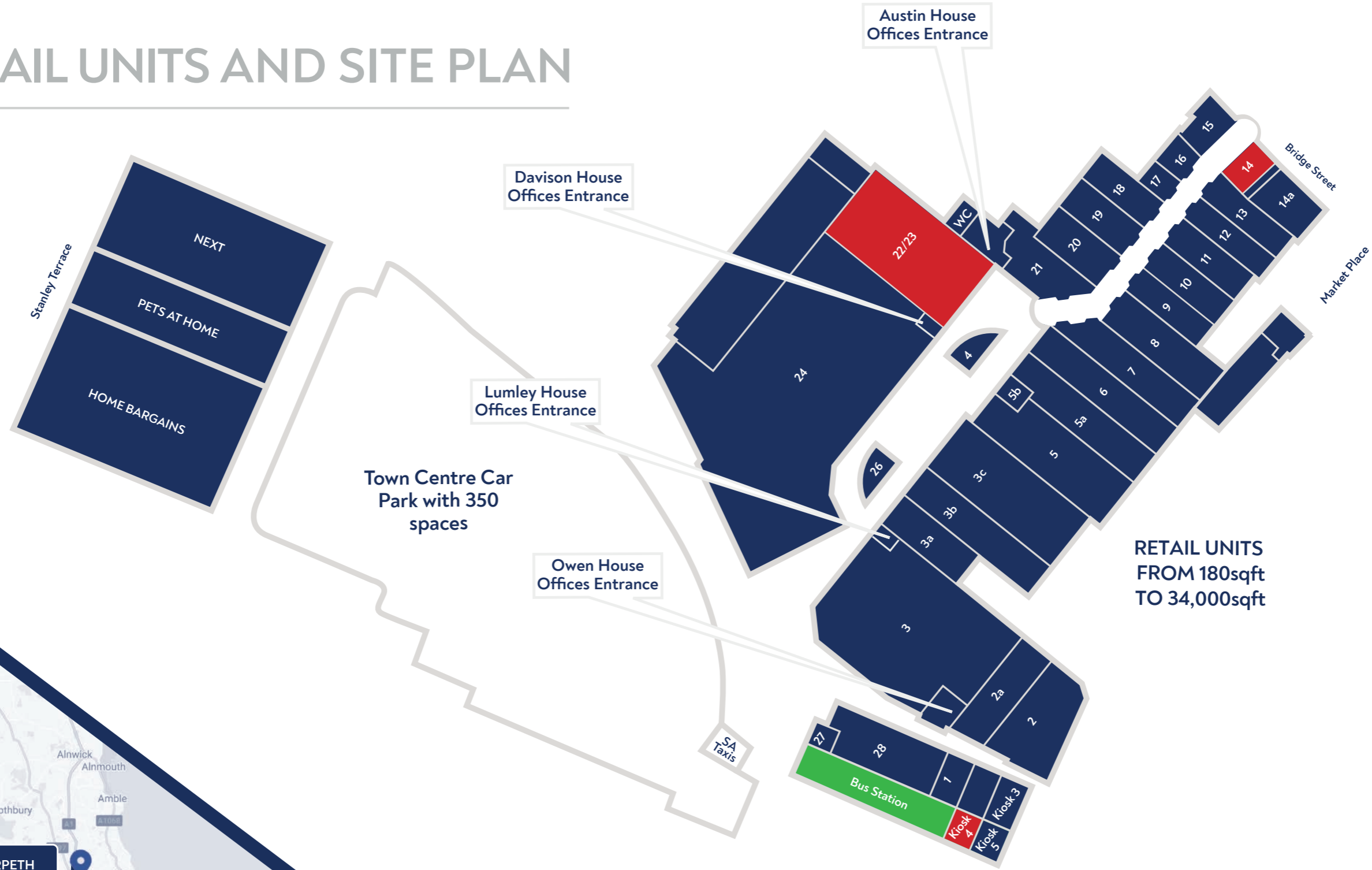

RETAIL UNITS FROM 180sqft TO 34,000sqft



LOCATION OF MORPETH

STORE DIRECTORY

1	Martin McColl	3b	Phase Eight	9	Crew Clothing	19	O2
2	Ladbrokes	3c	Mountain Warehouse	10	Mr Simms Sweet Shop	20	The Body Shop
2a	Card Factory	3d	Barluga Restaurant	11	Vision Express	21	Central Bean
3	Sandersons	4	Signature North East	12	Vodafone	22/23	UNIT TO LET
3a	JoJo Maman Bebe	5	Waterstones	13	Hobbs	24	Marks & Spencer
		5a	Mint Velvet	14	UNIT TO LET	26	Timpson
		5b	Deborah Green Jewellers	14a	EE	27/28	The Morpeth Larder
		6	Clarks	16/17	Gray & Co	Kiosk 3	The Eyebrow Gallery
		7	Seasalt	18	Market Cross Jewellers	Kiosk 4	UNIT TO LET
		8	Fat Face			Kiosk 5	Arriva

OFFICE SPACES

Located on the 1st floor of Austin, Davison, Lumley & Owen House

- From 170sqft to 3,500sqft
- Lift access
- High specification
- Suit a variety of uses

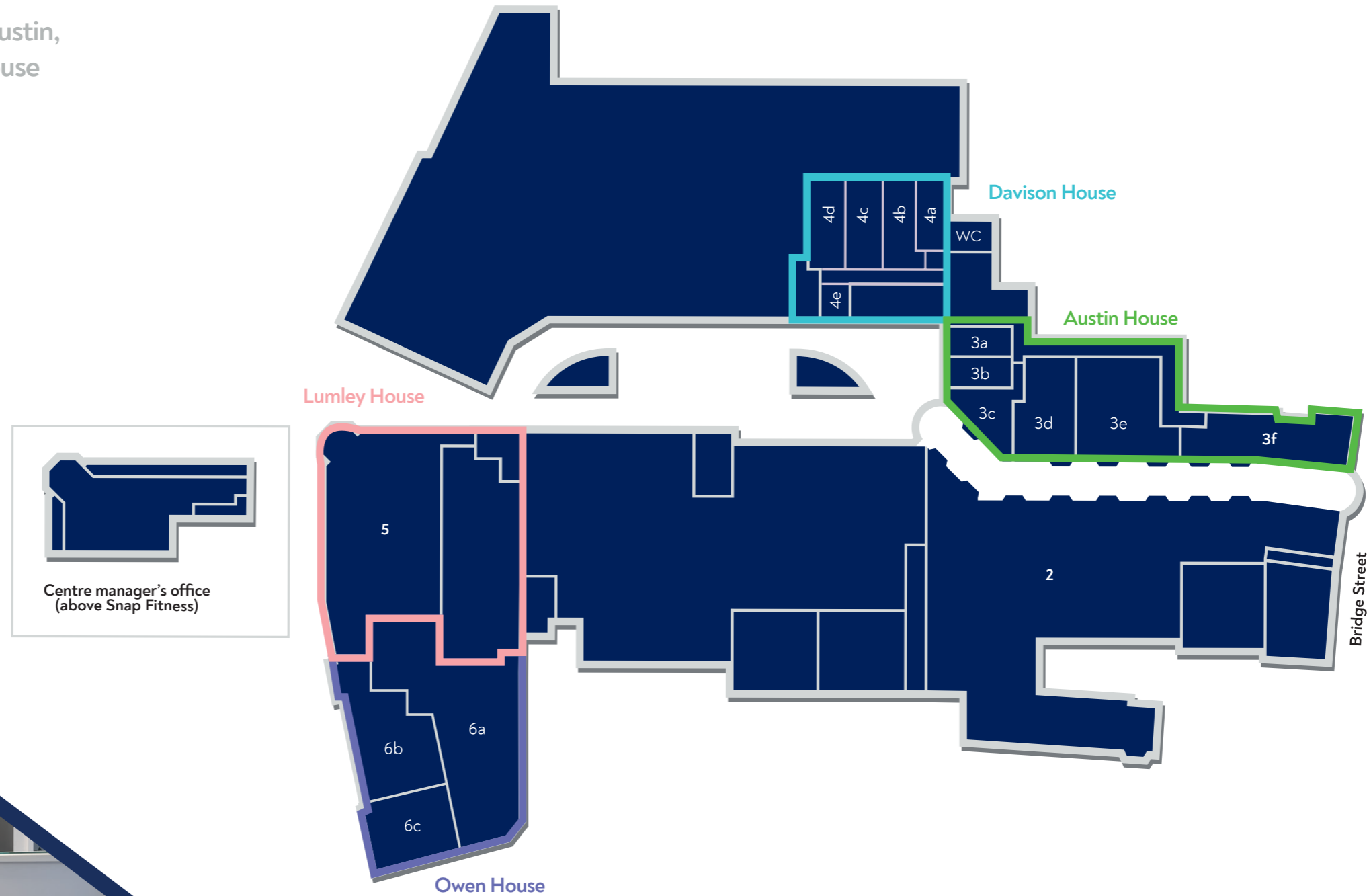

1	Centre Managers Office	4b	Bridal Reloved
2	Comrades Club	4c	SG Aesthetics
3a	Castle Chiropractic	4d	Roll Lift
3b	Pinky's Nail Boutique	4e	Riverstone Wealth Management
3c	Handelsbanken	5	Snap Fitness
3d	Talentheads	6a	Karbon Homes
3e	Northumbria Police	6b	D&P Asset Management
3f	Handelsbanken	6c	Dacre St Developments
4a	Advice 4 Business		





Sanderson Arcade in Numbers

15 miles north of Newcastle in the beautiful Market Town of Morpeth

55,000 people per week (average footfall)

350 space town centre car park and a bus interchange

230,788 people in a 20 minute drive and 808,174 in a 30 minute drive

Launched in 2009 by Joanna Lumley OBE – welcoming its 25 millionth customer in 2019

Northumberland in Bloom Gold Award Winner

Adjacent town centre development with Next, Pets at Home and Home Bargains

42% of the 10 minute drive catchment falls into the three most affluent Acorn groups.

next

pets at home

home bargains
TOP BRANDS - BOTTOM PRICES





Events at Sanderson Arcade



Festive and special themed events are held throughout the year including an annual food festival.

Live entertainment and children's events held in Sanderson Arcade's piazza area.

Christmas lights switch on event.

The annual Morpeth Food and Drink Festival attracts over

50,000
visitors every year



CONTACT US:  **Dransfield**
EST. 1992
PROPERTIES LIMITED

For further information about Sanderson Arcade and to arrange a viewing contact:

Olly Jansen
Estates Surveyor at Dransfield Properties
01226 360644 or 07843358335
olly.jansen@dransfield.co.uk

James Shepherd
Estates Director at Dransfield Properties
01226 360644 or 07789 817880
james.shepherd@dransfield.co.uk

www.sandersonarcade.co.uk

 @sandersonarcade  @SandersonArcade  @sandersonarcade

